



The Universal Drive

Motor capacity between 0.4 and 400kW

Dynamic torque vector control

Stand still torque

Optimised smoother low speed rotation

Guided low speed running and flying start

Internal PID control

Certified according to world-wide standards

FRN G11S-4EN – the combination of performance and functionality



Fuji Electric is one of the leading companies in drive and automation technology. Frequency inverters by Fuji Electric have been displaying their high quality standards and extensive performance spectrum for more than 25 years. The manufacturer's "know-how" and the world-wide availability of Fuji Electric guarantee safe implementation in machinery and systems.



Dynamic torque vector control (with/without sensor)

- Breakaway torque: 200% at 0.5Hz
- Stand still torque
- Fast reaction times
- Control range 1:1200

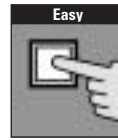

Simple operation

- Intelligent keypad with copy function in six languages
- Online tuning and continual monitoring of the motor data
- RS485 as standard (RS232 optional), windows software

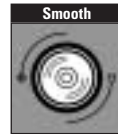

Optimised low speed rotation

- Excellent rotational performance
- Concentric ripple at 1Hz reduced by more than 50%

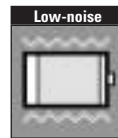

Environmentally-friendly functions

- Latest IPM technology minimises interference in sensor / actuator level
- Minimum motor noises for high and low switch frequencies alike
- Temperature controlled cooling fan

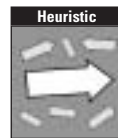

Self tuning

- Flying start in both directions
- Input phase loss protection
- Minimised inverter and motor losses due to automatic energy-saving function

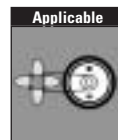

Application

Main drive units for textile, plastics and wood industry, air conditioning, fans, pumps, presses, machine tool, mechanical handling and elevators etc.

FRN G11S

FRN G11S-4EN – General specification

Standard motor rating	KW	0.4	22	30	75	90	400
Rated capacity	KVA	1.1	34	45	114	134	570
Output voltage	V	3 phase, 0-U _N					
Nominal current	A	1.5	45	60	150	176	750
Over voltage	V	200% for 0.5s, 150% for 1min.		180% for 0.5s, 150% for 1min.			110% for 1 min.
Input voltage	V	3-phase, 380V - 480V, 50/60Hz					
Voltage/Frequency tolerance		Voltage +10 to -15%, Frequency +5 to -5%					
Protection type (IEC 60529)		IP40			IP00 (IP20 optional)		
Cooling system		Self-cooling			Fan		
Ambient temperature range		-10°C to +50°C (without performance reduction)					
Standards		UL / cUL, Low voltage guideline, EMC Guideline, TÜV (up to 22 kW), IEC 61800-2, IEC 61800-3					

Dealer:

Fuji Electric FA Europe GmbH
 Goethering 58
 63067 Offenbach/M.
 Germany
 Tel.: +49 69 66 90 29 - 0
 Fax: +49 69 66 90 29 - 58
 www.fujielectric.de
 info_inverter@fujielectric.de

